

YAMAHA

Marine

Outboards

30HP

(3 cylinder)

REMOTE CONTROL ATTACHMENT KIT INSTALLATION MANUAL



YAMAHA MOTOR CO.,LTD.

6J8-48501-03 ●

COMPONENT PARTS

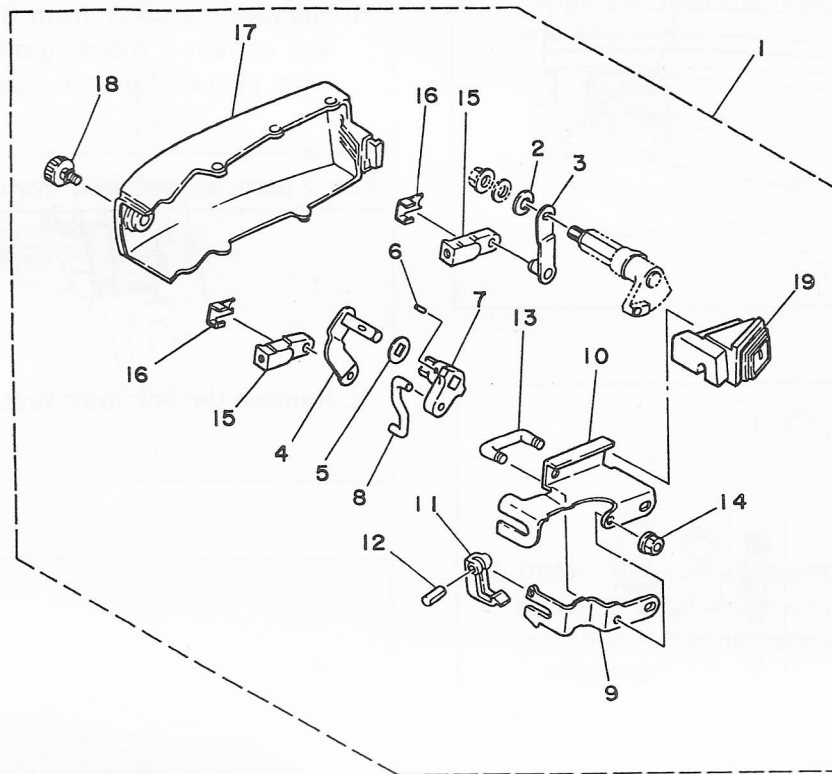

Ref. No.	Description	Q'ty	Remarks
1	Remote cont. attachment assy	1	
2	• Washer, spring	1	
3	• Throttle lever, control	1	
4	• Lever, shift control	1	
5	• Washer	1	
6	• Pin, spring	1	
7	• Lever, shift control	1	
8	• Joint	1	
9	• Bracket, remote control 1	1	
10	• Bracket, remote control 2	1	
11	• Clamp, cable 1	1	
12	• Pin, spring	1	
13	• Bolt	1	
14	• Nut	2	
15	• End, cable	2	
16	• End, cable 2	2	
17	• Cover, bottom	1	
18	• Screw	1	
19	• Grommet	1	

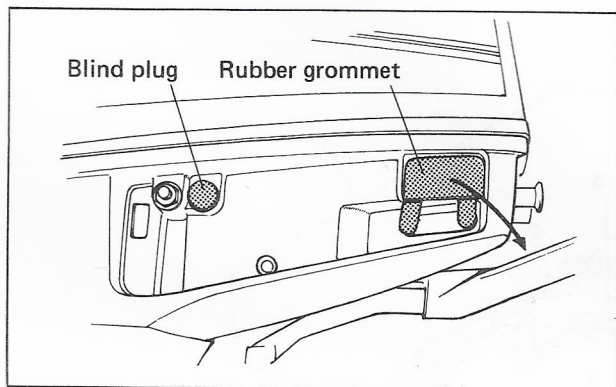

INSTALLATION

1. Remove the cover from the bottom cowling and extract a rubber grommet and a plastic blind plug as shown in illustration.

NOTE:

Above parts are not used from now on.

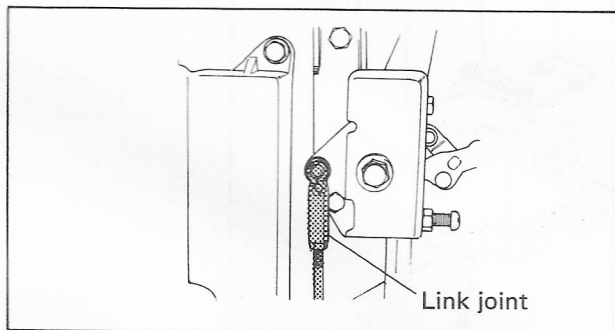

2. Remove the link joint first.

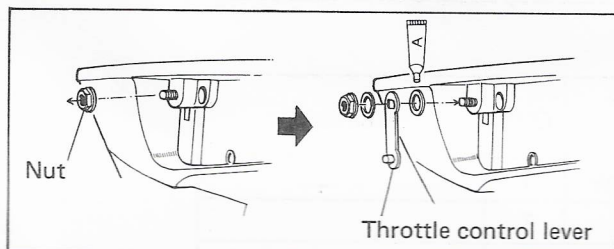

3. Remove the nut from the throttle control lever shaft and re-install parts with the throttle control lever as shown in illustration.

NOTE:

Apply grease with re-installation.

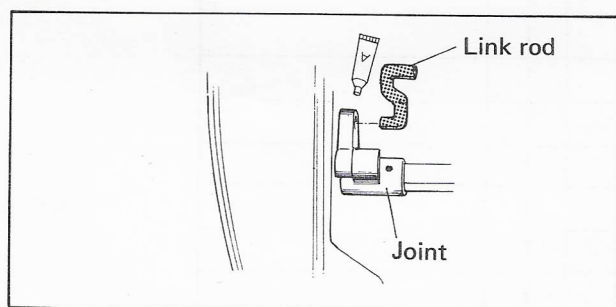

4. Insert the link rod into the joint hole and hold it vertically.
Apply grease before assembly.

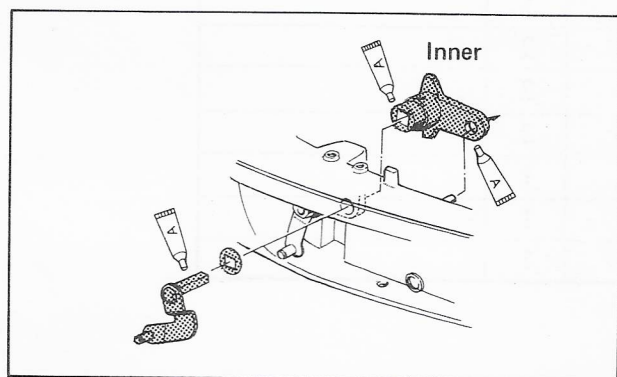

5. Apply grease to the shift control lever (inner) and install it to the bottom cowling and the link rod.
6. Insert the shift control lever (outer) with the plastic washer to the rectangular hole in the shift control lever (inner).

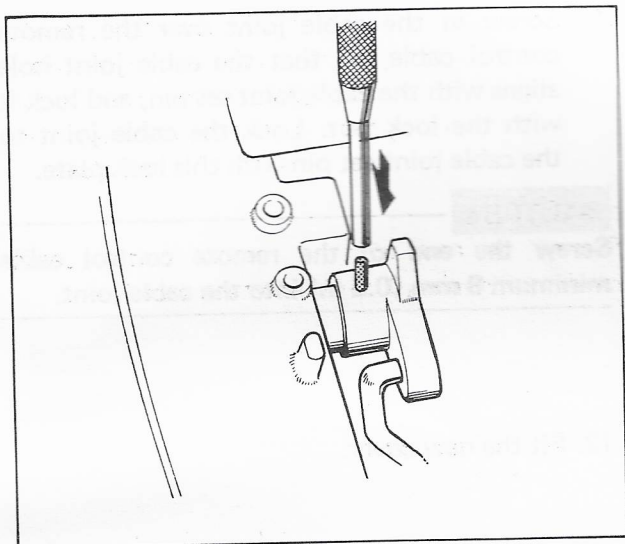

7. Align the spring pin holes and drive the spring pin into the hole by using rod driver and a hammer.

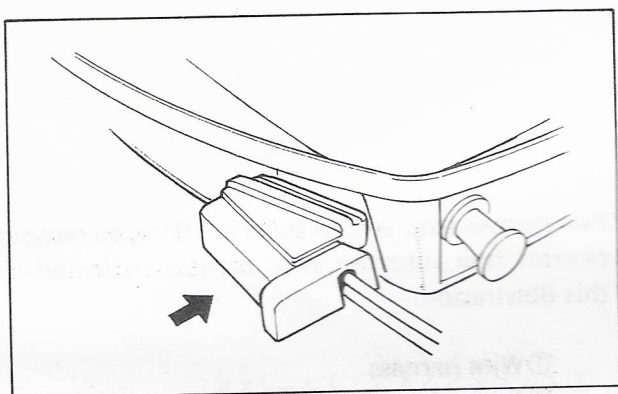

8. Install the rubber grommet to the bottom cowling. Lead the wire harness through the grommet if it is necessary.

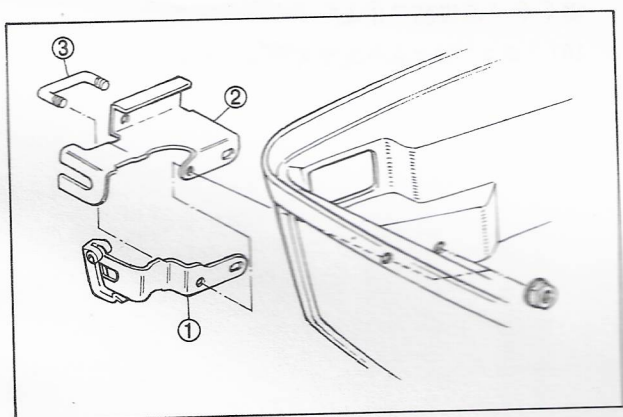

9. Below three parts should be assembled separately, as a sub assembly and installed to the bottom cowling.

- ① Remote control bracket 1
- ② Remote control bracket 2
- ③ Bolt

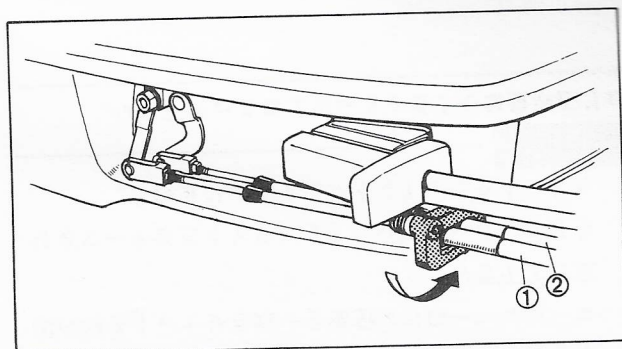

10. Connect the remote control cables to the remote control bracket.
(Shift side first)

NOTE:

Fit in place the throttle cable and the shift cable to the bracket, and hold them with the clamp.

- ① Throttle cable
- ② Shift cable

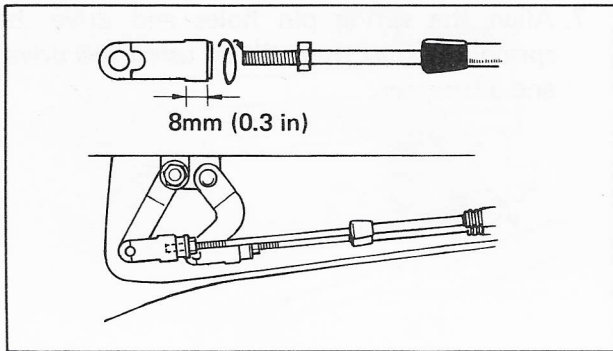

11. Screw in the cable joint over the remote control cable, so that the cable joint hole aligns with the cable joint set pin, and lock it with the lock nut. Lock the cable joint to the cable joint set pin with this lock plate.

CAUTION:

Screw the end of the remote control cable minimum 8 mm (0.3 in) into the cable joint.

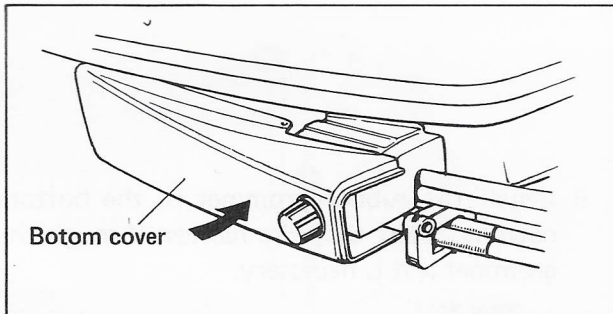

12. Fit the new cover.

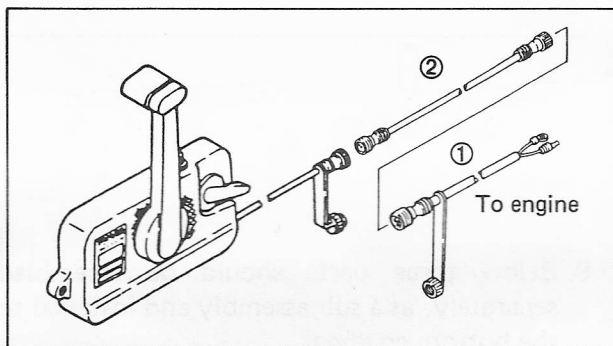

For remote stop switch built in 701 type remote control box, use the wire harness indicated in this illustration.

- ① Wire harness
- ② Extension wire (2m)